

Kaynak Bölgesi
Kaynak Ağızı Δ 4mm

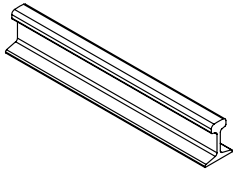
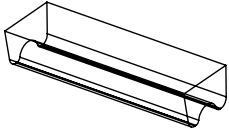
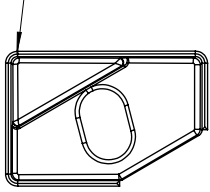

Krapo Özellikleri

Ürün Kodu	C Max	Sıkma Kuvveti	Kabuledilebilir Yük	Ağırlık	Hammadde
CRAPEX 400	33 mm	200 Nm	75 kN	0,65 kg	DIN 17100 S 355 J2

Kaynak Bilgileri:

DIN 17100 - Wst Nr: 1.0562 :S 355 J2
NFA 35-501: E36-3
BS 4360 : 50 C
EURO NORM 10025 : S355 JO

Elektrod Bilgileri:

DIN 1931 : E51 55B 10 110
AFNOR 81-309 : E51 5/5B 110 26 BH
ISO 2560 : E51 5B 110 26
ASME IIC SFA 5.1 : E 7018-1

Kauçuk Bilgileri

Sertlik	75° +/- 5°
Çekme Mukavemeti	12,5 N/mm ²
Genleşme	90%
Çalışma Sıcaklığı	-30° - 130° C
Titreşim Azaltma	45% - 50%
Ses Azaltma	8% - 10%

Ray Tipi	A	B	E	Ağırlık kg/m	Pedli	Pedsiz
A45	45	55	125	22,1	105	105 P
A55	55	65	150	31,8	105	105 P
A65	65	75	175	43,1	105	105 P
CR 104	63,5	127	127	51,59	105	105 P
CR 105	65,1	131,8	131,8	52,09	105	105 P
CR 135	76,2	146	131,8	66,97	105	105 P
S 24	53	115	90	24,43	105	105 P
25 kg/m	50	115	90	25	105	105 P
S 26 (AFNOR)	50	110	10	26,27	105	105 P
27 E1 (27 UNI)	50	120	95	27,06	105	105 P
AFNOR 30	56	125,5	106	29,98	105	105 P
30 E1 (S 30)	60,3	108	108	30,13	105	105 P
33 E1 (S 33)	58	134	105	33,47	105	105 P
36 E1 (36 UNI)	60	130	100	36,26	105	105 P
40 E1 (S 41-R)	67	138	125	40,95	105	105 P
46 E4	65	145	135	46,9	105	105 P
49 E1	67	148	125	49,39	105	105 P
54 E1	70	159	140	57,77	105	105 P
60 E1	72	172	150	60,21	105	105 P

